

49, Oxford Street, Weston-Super-Mare, North Somerset, BS23

Auction Guide Price +++ £275,000



- FOR SALE BY ONLINE AUCTION
- WEDNESDAY 14TH MAY 2025
- VIDEO TOUR NOW ONLINE
- VIEWINGS - REFER TO DETAILS
- LEGAL PACK COMPLETE
- MAY LIVE ONLINE AUCTION
- FREEHOLD MIXED USE BLOCK
- INVESTMENT | £37,800 PA
- NIGHTCLUB | 2 X 3 BED FLATS
- EXTENDED 8 WEEK COMPLETION

Hollis Morgan – MAY LIVE ONLINE AUCTION - A Freehold HIGH YIELDING INVESTMENT comprising a MIXED USE BLOCK (4321 Sq Ft) producing £37,800 pa | Nightclub / 2 X 3 Bed Flats

49, Oxford Street, Weston-Super-Mare, North Somerset, BS23 1TN

Accommodation

FOR SALE BY LIVE ONLINE AUCTION

ADDRESS | 49 Oxford Street, Weston-super-Mare, North Somerset BS23 1TN

Lot Number TBC

The Live Online Auction is on Wednesday 14th May 2025 @ 17:30
Registration Deadline is on Monday 12th May 2025 @ 16:00

The Auction will be streamed LIVE ONLINE via the Hollis Morgan website & you can chose to bid by telephone, proxy or via your computer.
Registration is a simple online process – please visit the Hollis Morgan auction website and click “REGISTER TO BID”

THE PROPERTY

A Freehold mixed use property with accommodation (4321 Sq Ft) arranged over three floors and located just moments from the sea front.

Ground Floor - Nightclub / Bar

First Floor - Self contained 3 bedroom flat with access from rear

Top Floor - Self contained 3 bedroom flat with access from rear

Tenure - Freehold

Council Tax - A & A

EPC - C & D

THE OPPORTUNITY

MIXED USE INVESTMENT

The property currently produces £37,800 pa - please refer to legal pack for copies of leases.

Scope for Break up subject to VP.

SCHEDULE OF INCOME

Ground Floor - £1200 pcm | £14,400 pa (5 year lease from September 2024)

First Floor - £950 pcm | £11,400 pa on AST (Now rolling | Periodic)

Top Floor - £1000 pcm | £12,000 pa on AST (Now rolling | Periodic)

LOCATION

Weston Super Mare is a popular seaside town located on the Bristol Channel coast of North Somerset situated approximately 18 miles (29 km) south-west of Bristol and has a population of approximately 80,000 people. The town has a long history as a popular holiday destination, with a sandy beach that stretches for over two miles (3.2 km) and a variety of attractions and activities for visitors. The town centre has a mix of old and modern buildings, with several historic landmarks such as the Grand Pier, the Winter Gardens Pavilion, and the Birnbeck Pier. Westons main attraction is its beach, which is backed by a wide promenade and a range of amenities such as cafes, restaurants, and shops. The Grand Pier is a popular destination for families, with a variety of fairground rides, arcade games, and attractions. The town also has several parks and green spaces, including the 12-acre Grove Park, which has a children's play area, a boating lake, and a miniature railway. Other popular parks include Clarence Park and Ashcombe Park, both of which offer picturesque settings for picnics and walks. Weston is well connected with the M5 motorway running nearby and regular train services to Bristol, Bath, and other major cities. The town also has its own railway station, which is located within walking distance of the town center and the beach.

Floor plan

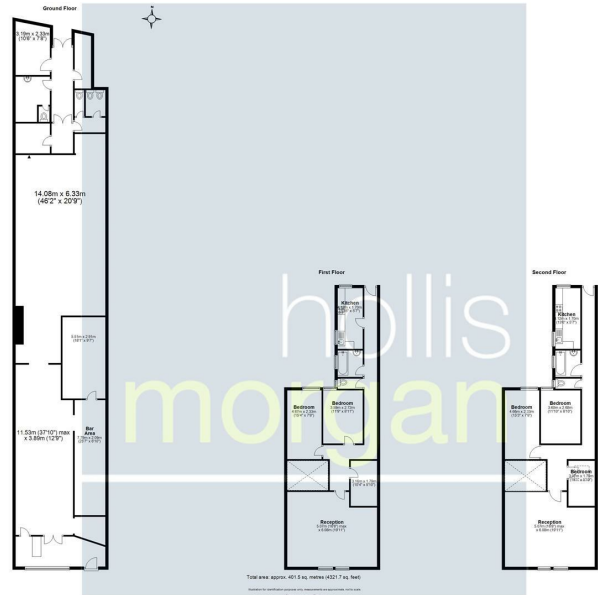

EPC Chart

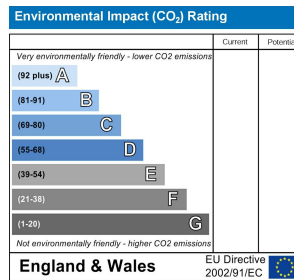
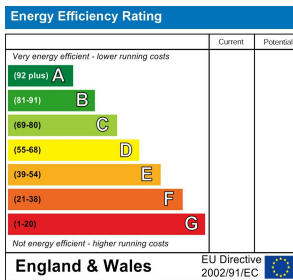

9 Waterloo Street

Clifton

Bristol

BS8 4BT

Tel: 0117 973 6565

Email: post@hollismorgan.co.uk

www.hollismorgan.co.uk

Hollis Morgan Property Limited, registered in England, registered 7275716.

Registered address, 5 Upper Belgrave Road, Clifton, Bristol BS8 2XQ

Auction Property Details Disclaimer

Hollis Morgan endeavour to make our sales details clear, accurate and reliable in line with the Consumer Protection from Unfair Trading Regulations 2008 but they should not be relied on as statements or representations of fact.

Please refer to our website for further details.